

No.	Name	Material	No.	Name	Material
1	Nylon Plug MB	Polyamide PA 6	3	Nylon Plug MN	Polyamide PA 6
2	Screw with head hole M5 / T40	Zinc plated steel	4	Screw with head hole M5 / T40	Zinc plated steel

Building materials

Qualities



Characteristics

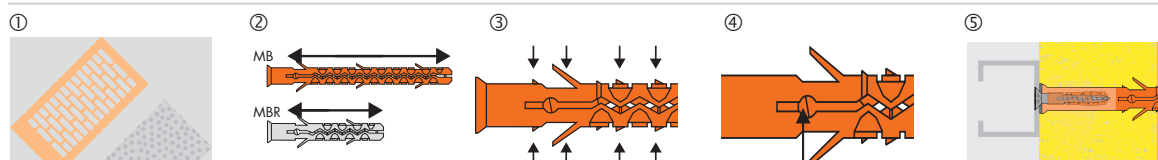

- ① Suitability - Recommended and suitable for most applications in perforated brick and aerated concrete
- ② Expansion zone - MB with extended expansion zone for optimum applications in low density materials and hollow brick
- ③ Rotation resistance - Stops the plug rotating in the drill hole

- ④ Knock-in protection - Prevents premature expansion while installing
- ⑤ Bridging of non-bearing wall materials: the application of the building materials occurs exclusively on the bolt head

Applications

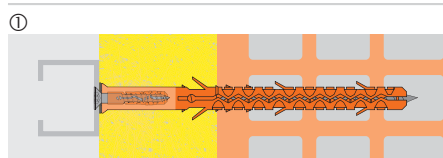

- ① Ideal fastening of items as lamps, roller blinds, rails etc. on thin insulations

Installation

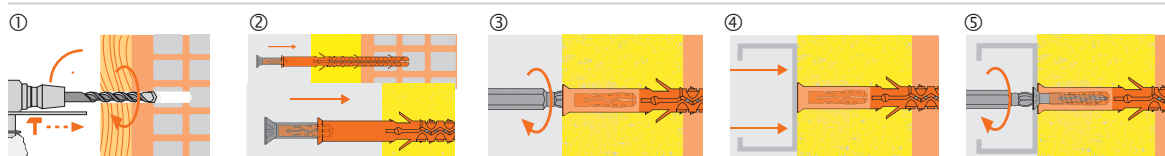

- ① Position the fixture and drill the hole simultaneously through the isolation into the building material. Take drill hole- \varnothing and -hole depth from the table
- ② Insert the screw into the plug
- ③ Tighten the screw with the blank head hole
- ④ Position the building materials and put the screw with the plug into the head hole
- ⑤ Tighten the building materials with the screw in the bolt head

- ② Insert the screw into the plug
- ③ Tighten the screw with the blank head hole
- ④ Position the building materials and put the screw with the plug into the head hole
- ⑤ Tighten the building materials with the screw in the bolt head

MB-SK with plug

Plug size		10						
Recommended tension loads:								
N _{Emp}	- Perforated brick	kN	1.6					
	- Aerated concrete		0.8					
h _{ef}	Effective anchorage depth	mm	70					
d _{s1}	Screw-Ø	mm	4					
h ₁	Drill hole depth	mm	90					
d ₀	Drill hole-Ø in the building material	mm	10					
d _f	Clearance hole in fixture	mm	10					
l	Plug length	mm	80	100	120	140	160	200 240
d _{nom}	Outside-Ø plug	mm	10					
d _{nom1}	Outside-Ø plug head hole	mm	5					
t _{fix}	Assembling usable length	mm	10	30	50	70	90	130 170

**MB-SK with plug MN 5****Safety Screw SR-SK with head hole M5/T40**

Screw size		7						
Recommended tension loads:								
N _{Emp}	- Perforated brick	kN	1.6					
	- Aerated concrete		0.8					
d _s	Screw-Ø	mm	7					
l _s	Screw length	mm	105	125	145	165	205	245
l _G	Internally thread max. usable	mm	18					
d	Internally thread	M	5					

**SR-SK Safety Screw with internal thread M5/T40**